



CERTIFICATE OF LAND

Appendix X

File No.

Date:

Certified that the land measuring 12,140.5 sqmtr is owned by the Siddhi Vinayak Public School by way of Sale deed (In case of allotment of land, if it is not perpetual, periodicity of allotment to be mentioned from to).

It is further certified that owner of the land has leased the said land to (Name of the School/Society/Trust/Company under Section 8 of companies Act, 2013) fully described in the schedule mentioned hereinafter with the following details for a period of years from to

SL	Particulars	Details
1.	Plot No. (s)/ Survey No. (s)/Khasra No. (s)/Khata No.(s)/Khatauni No.(s)	Plotno 277/568/817, Khata-153/748 Plotno 277/568/Khata-153/778
2.	Name of street/village, Sub Division, District and State	Juphesthipur, Balasore

It is certified that the said entire land comprise of a single contiguous plot of land. It is further certified that Siddhi Vinayak Public School (Name of the School with name of street, village, sub-division and district) run by name of Maa Tarini Edu. Society (Society / Trust / Company under Section 8 of companies Act, 2013) is located on the said plot of land.

THE SCHEDULED OF LAND ABOVE REFERRED TO

All that piece and parcel of land measuring 12,140.5 (area of land in square meters) situated in 277/568 (Plot No. (s)/Survey No.(s)/ Khasra No. (s)) at Juphesthipur (name of street/village, sub division, district and state) and bounded as follows: 277/568/817

- North 277/568 Maa Tarini Charitable Trust : Maa Tarini Charitable Trust
- East Govt. Road : Govt. Road
- West 25 link Road : 25 link Road
- South Siddhi Vinayak Public School : 275, 276

DM/ ADM/ SDM/ TEHSILDAR/ NAIB TEHSILDAR/ REGISTRAR/ SUB- REGISTRAR/EQUIVALENT LAND AUTHORITY

(Stamp and Signature of the land authority)

Tahsildar Balasore

(Name of District)

\* The filled up certificate should be either in Hindi or English. If it is issued in vernacular language, translated notarized version in English be uploaded along with the original vernacular certificate as a single pdf.



MOUZA → JOJESTIPUR  
THANA → BALASORE SADAR NO-166  
DIST → BALASORE  
SCALE → 32" = 1 MILE

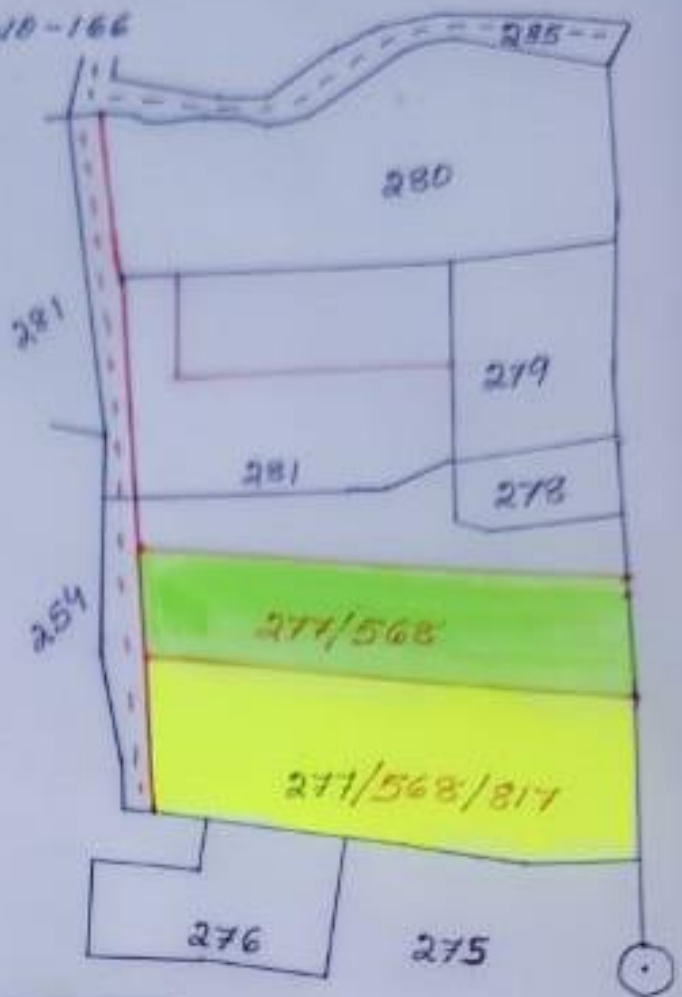

"REFERENCE"

PLDT BOUNDARY LINE: \_\_\_\_\_

PLDT PARTITION LINE: \_\_\_\_\_

PROPOSED COMMON ROAD: -----

CONVERSION PLOT SHOWN IN GREEN COLOUR:

CONVERSION PLOT KHATA NO → 153/777

PLDT NO → 271/568 (part)

AREA → 11.000 DEC